



SafeRack

LOADING RACK TECHNOLOGIES

730 Electric Drive | Sumter | SC | USA | 29153 | +1-803-774-7225

G4 SERIES

SAFERACK SAFE ACCESS SYSTEM

SafeRack access platforms and stairs provide safe access to the tops of road and railcar, while the safety cage ensures superior fall protection for the operator, once on top of the tanker.

The decision to install SafeRack equipment has the following benefits:

- ONLY SafeRack platforms and stairs require less than 35 pounds of lateral force to raise or lower; less chance for muscle strain or operator injury.
- ONLY SafeRack products have been engineered with no pinch points, eliminating unnecessary hand injuries.
- ONLY SafeRack uses special bushings at the pivot points and the load bearing pivot rods. These self-aligning bushings reduce wear and maintenance issues. Without these bushings, the platforms and stairs become shaky and more difficult to raise and lower over time.
- ONLY SafeRack equipment is manufactured using CNC technology, ensuring precision to one thousandth of an inch, unlike our competitors who merely fabricate by hand. Considering there are a minimum of 16 pivot points in a standard access stairway, alignment requirements must be precise for long-lasting equipment.
- ALL SafeRack equipment meets or exceeds OSHA guidelines, as we interpret them.



The SafeRack truck loading station comprises:

A platform with access stairway, retractable gangway and a four rail aluminum safety basket providing fall protection for the operator while working at height. Customized platform and gangway dimensions are available to meet specific requirements. Please see gangway sizing chart [pages 2 & 3].

SafeRack personnel have been in this industry for a combined 250+ years, which gives us a tremendous amount of knowledge that we bring to you. This knowledge allows us to provide the highest quality equipment as well as the excellence in service on your project.

SafeRack's manufacturing, installation, customer service and sales people have only one goal, and that is to provide the proper equipment and service during and after the sales.



Variations in truck height are easily serviced by the self adjusting stair SAS Series gangway.
Visit www.SafeRack.com or call +1-803-774-7225 for technical assistance.

Zacatepetl 363 A, Delegación
Tlalpan 14010 México, D.F.
Tel- +52 (55) 5606-1611,
e-mail:
promtec@promtec.com.mx



PROM TEC, S.A. DE C.V.



SafeRack

LOADING RACK TECHNOLOGIES

730 Electric Drive | Sumter | SC | USA | 29153 | +1-803-774-7225

G4SERIES

Stronger, Safer, Easier to operate loading stations.

Layout drawings with foundation loads provided with order.

Manufactured in accordance to DIN 31003, with static approval.

Max. foundation design:

Bending moment = 93.9 KNm

Vertical force = 78.6 KN

Horizontal = 4.1 KN

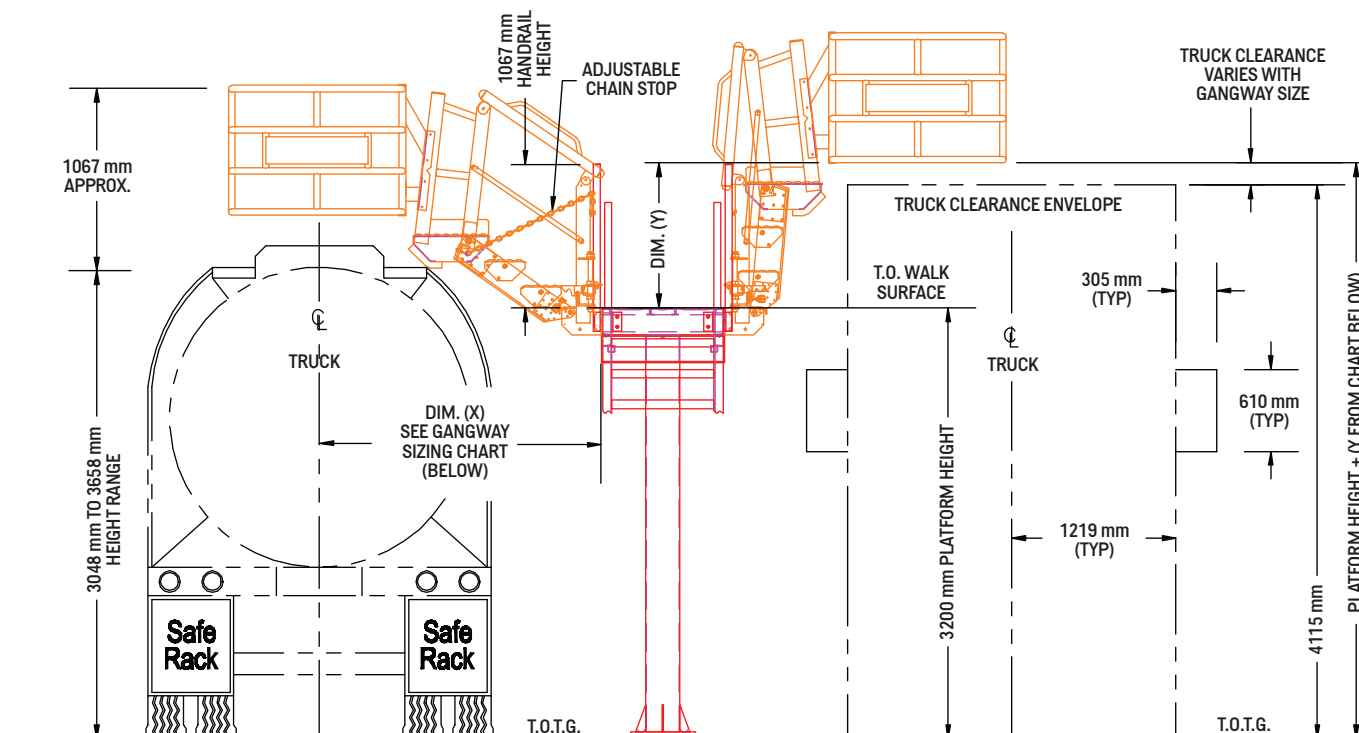

End Elevation View On Truck

End Elevation Stored View

Double Hatch Tank Truck Loading Rack "TANK TRUCKS ONLY"

Gangway Sizing Chart (Tank Truck)

Dim. (X)	Model #	Dim. (Y)
1829 mm	G4-SAS-24-3	679 mm
2134 mm	G4-SAS-24-4	1008 mm
2438 mm	G4-SAS-24-5	1337 mm
2743 mm	G4-SAS-24-6	1665 mm
3048 mm	G4-SAS-24-7	1994 mm



PROM TEC, S.A. DE C.V.

Zacatepetl 363 A, Delegación
Tlalpan 14010 México, D.F.
Tel- +52 (55) 5606-1611,
e-mail:
promtec@promtec.com.mx

Variations in truck height are easily serviced by the self adjusting stair SAS Series gangway.
Visit www.SafeRack.com or call +1-803-774-7225 for technical assistance.



SafeRack
LOADING RACK TECHNOLOGIES

730 Electric Drive | Sumter | SC | USA | 29153 | +1-803-774-7225

G4SERIES

The SafeRack loading station is supplied with anti-skid gratings throughout. Platform, stairway, support column and gangway are bolted constructions for ease of installation.

Variations in tank truck height can be easily and safely accommodated by the self adjusting stair system.

The SafeRack team is here to help so please call us to discuss your specific requirements.

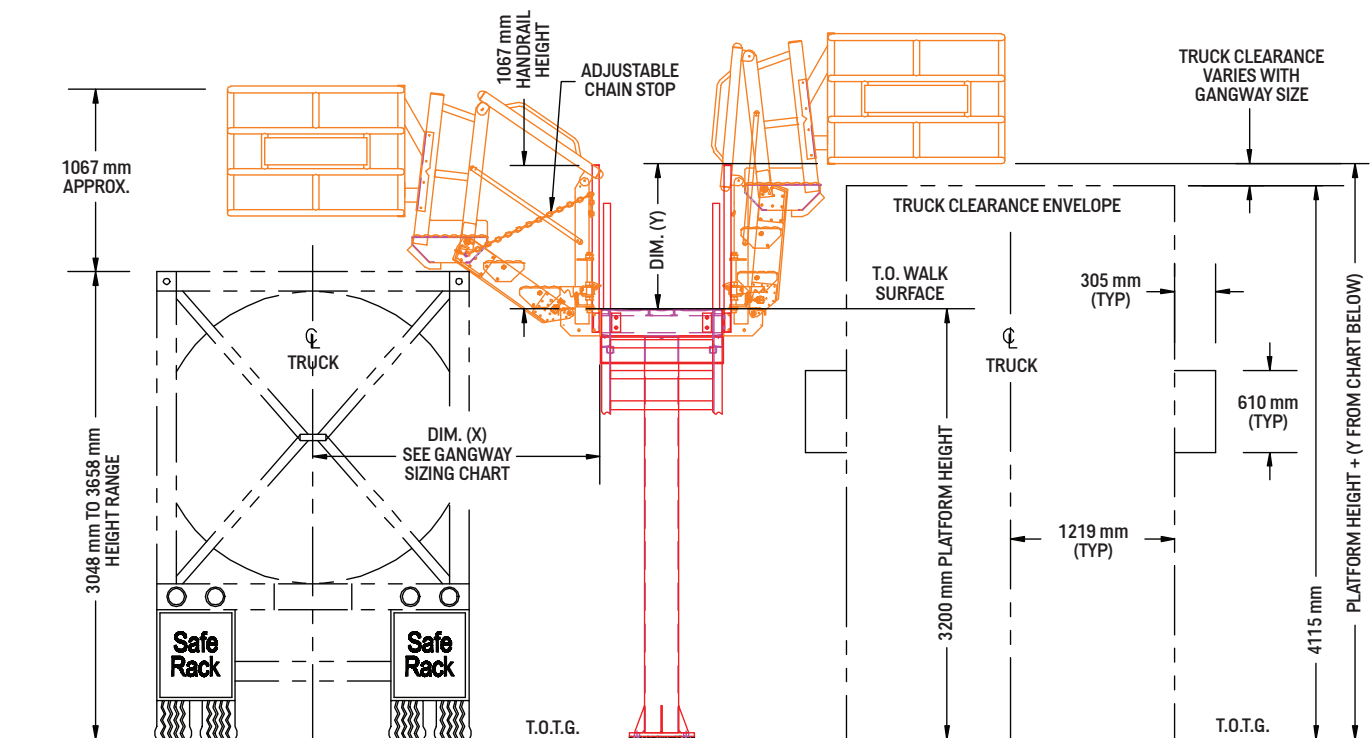

End Elevation View On Truck

End Elevation Stored View

Double Hatch Tank Truck Loading Rack “ISOTAINER TRUCKS AND STANDARD TANK TRUCKS”

Gangway Sizing Chart (Isotainer Truck)			
Dim. (X)	Model #	Dim. (Y)	Notes
1829 mm	G4-SAS-24-3 *, **	679 mm	* Requires 3658 mm Platform Height
2134 mm	G4-SAS-24-4 *	1008 mm	** Will not work with 3962 mm Isotainer
2438 mm	G4-SAS-24-5	1337 mm	
2743 mm	G4-SAS-24-6	1665 mm	
3048 mm	G4-SAS-24-7	1994 mm	

Variations in truck height are easily serviced by the self adjusting stair SAS Series gangway.
Visit www.SafeRack.com or call +1-803-774-7225 for technical assistance.

Zacatepetl 363 A, Delegación
Tlalpan 14010 México, D.F.
Tel- +52 (55) 5606-1611,
e-mail:
promtec@promtec.com.mx



PROM TEC, S.A. DE C.V.



SafeRack

LOADING RACK TECHNOLOGIES

730 Electric Drive | Sumter | SC | USA | 29153 | +1-803-774-7225

G4 SERIES

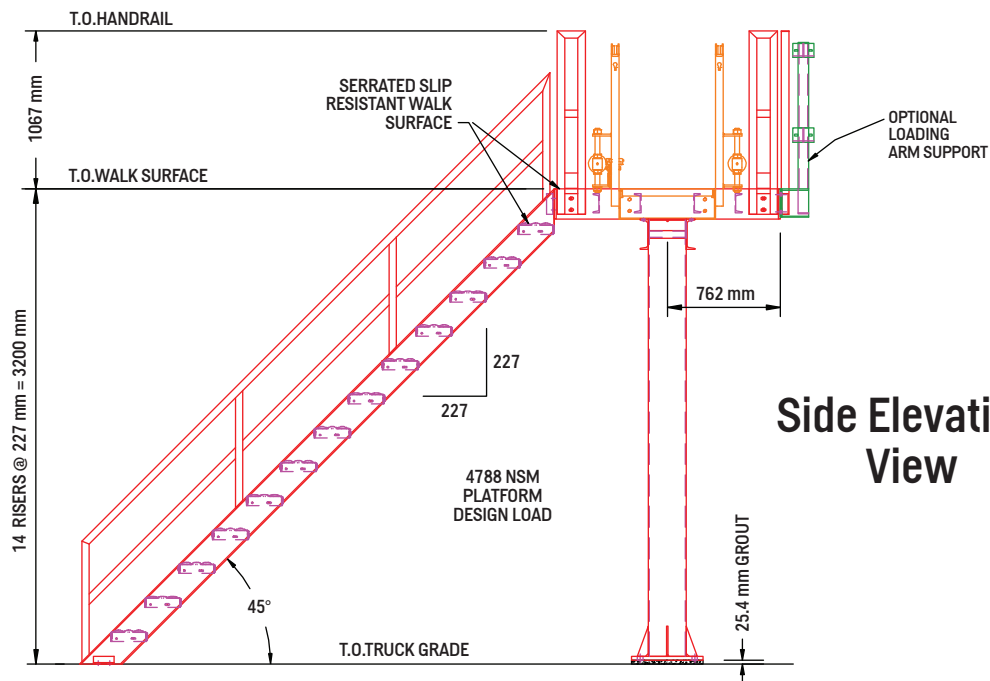
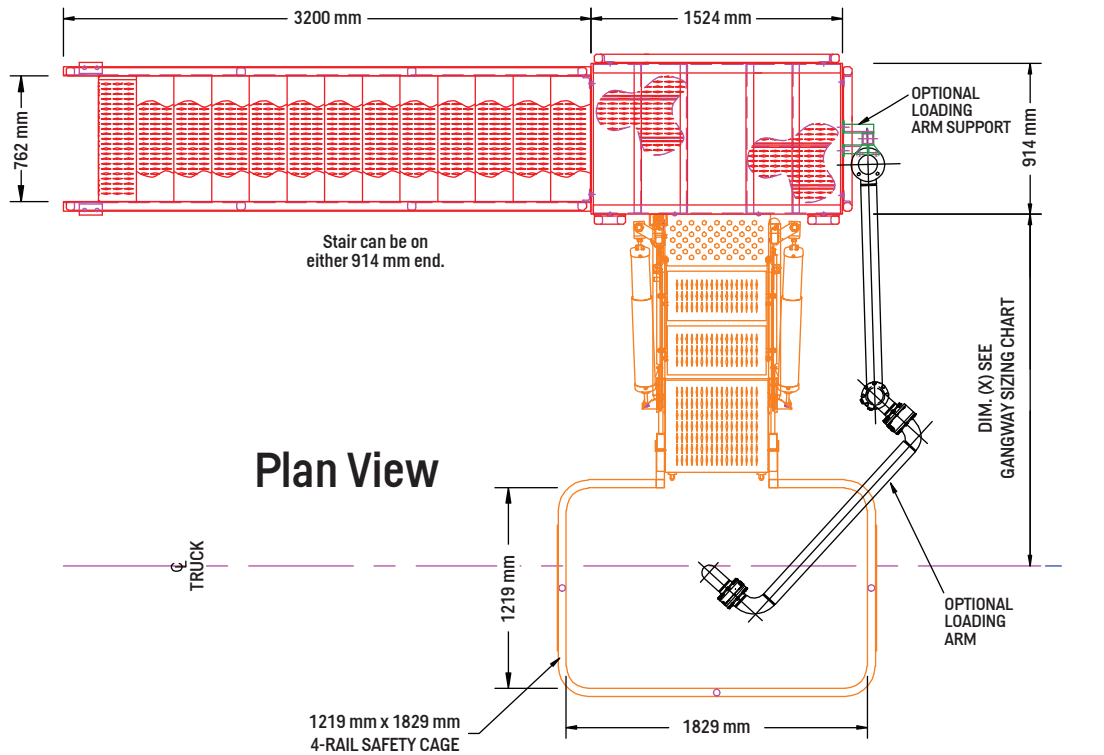

PROM TEC, S.R. DE C.V.

Zacatepetl 363 A, Delegación
Tlalpan 14010 México, D.F.
Tel- +52 (55) 5606-1611,
e-mail:
promtec@promtec.com.mx

Variations in truck height are easily serviced by the self adjusting stair SAS Series gangway.
Visit www.SafeRack.com or call +1-803-774-7225 for technical assistance.