



ST-15

Single Point Overfill Prevention Controller

Featuring Dynacheck® – Automatic and Continuous Self-Checking Circuitry



ST-15

DESCRIPTION

The Scully single point overfill prevention controllers feature two-wire optic or thermistor sensing. They are mounted at a loading rack or fill station for connection to a single compartment tank vehicle.

The ST-15 provides the vehicle with an adequate static ground path to the rack provided the vehicle overfill equipment is wired and maintained to factory specifications. For additional ground proving options, the system works in conjunction with the Scully Groundhog Self-Proving Ground Verification System.

FEATURES AND BENEFITS

- Maximum safety with Dynacheck® automatic and continuous self-checking circuitry.
- Will not permit loading under any fault or wet sensor conditions.
- Signals for automatic shut-off of product flow within a half-second of detecting an overfill condition.
- Ideal overfill prevention for refuelers, rail tank cars, tank trucks, chemical trailers and other one compartment vehicles.
- 30 years of proven, dependable performance.
- Easy connection to vehicles with versatile high impact plug and cable units.
- Approved by Factory Mutual



Technical Diagram of Model ST-15 ELK
All Dimensions in Inches (Millimeters in Parenthesis)

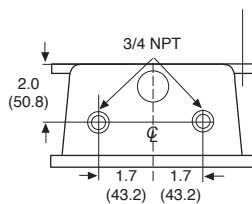

Top View

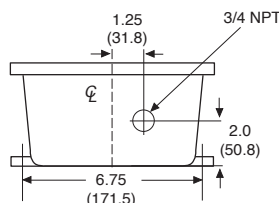

Bottom View

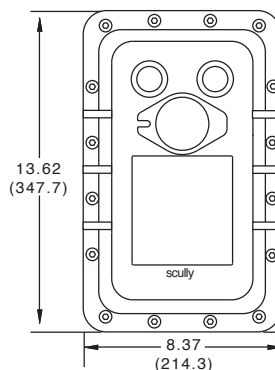

Front View

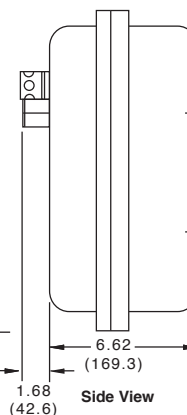

Side View

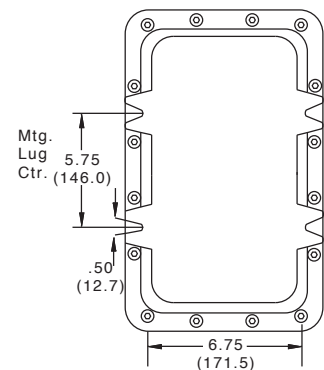

Back View



PROM TEC, S.A. DE C.V.

Zacatepetl 363 A, Delegación Tlalpan 14010
México, D.F. Tel- +52 (55) 5606-1611,
e-mail: promtec@promtec.com.mx

Single Point Overfill Prevention Controller

TECHNICAL SPECIFICATIONS

FM & CSA Approved Versions of:

Thermistor Sensors
SP-BL, SP-BLU, SP-BLH
Two-wire Optic Sensors
SP-TO, SP-TOM, SP-IO, SP-IR,
SP-TO(SS), SP-TO(SS)HP

Enclosures:

Explosion-proof, weathertight.
Corrosion inhibiting epoxy paint
optional.

Indicator Lamps:

Red = Power On/Non-Permit
Green = Permit

Approvals:

XP-AIS / I / 1 / CD / T6 Ta = -40°C
to 60°C; Entity – 61654;

XP-AIS/ I / 1 / IIB/ T6 Ta = -40°C
to 60°C; Entity 61654

Class I Zone 1 Group IIB

Turn on response time: 6 – 30 seconds (typical) for
thermistors. Two-wire optics turn
on instantly.

Shutdown

Response Time:

0.5 seconds maximum

Power Requirements:

105 - 130 VAC, 50-60 Hz, 20
watts maximum, 210 - 250 VAC
nominal, 50-60 Hz, 20 Watts
maximum

Connections:

Provided by internal terminal strips

Output Control:

One normally open volt free
contact, rated 250 VAC, 5A
resistive, energized when the
sensor is dry.

Output Control Fuse:

Internal 5 Amperes.

Size:

Refer to Diagram for EL & ELK
models.

Weight:

28 lbs. (12.7 kg) EL & ELK Units

NOTE: The Scully ST-15 is an intrinsically safe system. For maximum safety,
it should be used only in conjunction with sensors manufactured by Scully
not to jeopardize the conditions of the approvals.



ORDERING INFORMATION

Model	Description	Part Number
ST-15-115-EL	Single Point Controller with Explosion-proof Housing and Indicator Lamps, 115VAC	07528
ST-15-115-ELK	Single Point Controller with Explosion-proof Housing, Indicator Lamps, Lockable Bypass Switch, 115VAC	07677
ST-15-240-EL	Single Point Controller with Explosion-proof Housing and Indicator Lamps, 240VAC	07640
ST-15-240-ELK	Single Point Controller with Explosion-proof Housing, Indicator Lamps, Lockable Bypass Switch, 240VAC	07547

REPLACEMENT PARTS

115 VAC	Control circuit module only, ST-15-115H	08756
240 VAC	Control circuit module only, ST-15-240H	08656

Copyright © 2013 Scully Signal Company. Dynacheck, Dynamic Self-Checking, Dynamic Self-Test, Faylsafe, IntelliCheck, Intellitrol, Intelliview, Load Anywhere, Maxsafety, Sculcon, and V.I.P. are registered trademarks of Scully Signal Company. All Rights Reserved.
Specifications are subject to change without notice.



Dynamic Self-Testing® Overfill Prevention Systems



Zacatepetl 363 A, Delegación Tlalpan 14010
México, D.F. Tel- +52 (55) 5606-1611,
e-mail: promtec@promtec.com.mx